



Colour- and perfume-free protective lotion for normal skin

New formulation
with Jojoba Oil

sensiva[®] protective emulsion

Our Plus

- soft skin care
- protective lotion (according TRGS 401 - German regulation)
- easy-spreading
- does not reduce the effect of hand disinfection (desderman pure and desmanol pure)
- colour- and perfume-free
- dermatologically tested

Application areas

- to be applied to clean, dry hands
- special skin protection for normal and stressed skin
- for frequent use while working
- for use in the food processing industry

Product Profile

- oil-in-water emulsion
- contains Jojoba oil, which preserves the natural acid mantle (hydrolipidic film) of the skin through a balanced supply of fat and moisture and leaves no unpleasant greasy film
- nourishes the skin, making it smooth and resistant

Instructions for use

Apply and rub into the skin.
Apply to the back of your hand and rub at first the backs of your hands together, then the insides of your hands.
When applying pay particular attention to the places in between your fingers and the nail bed.
When applying product always use a pump or dispenser to prevent contamination..
Use it regularly during daily work especially before skin-stressed activities, e.g. when starting with your work, after breaks and after each hand cleansing.

The product does not contain perfume. Nevertheless, it may be that it does not always smell the same on the skin. This is because the skin structure of every human being is unique. Thus, an odorless product is perceived differently on different hands.

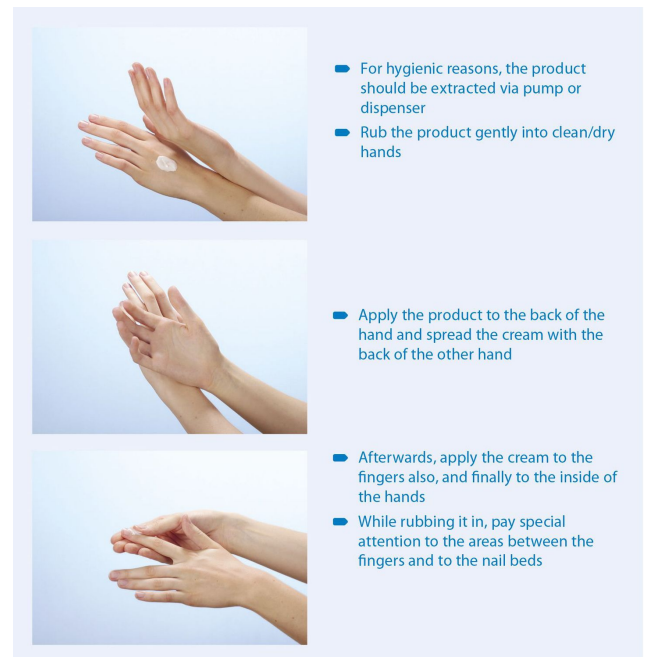

- For hygienic reasons, the product should be extracted via pump or dispenser
- Rub the product gently into clean/dry hands
- Apply the product to the back of the hand and spread the cream with the back of the other hand
- Afterwards, apply the cream to the fingers also, and finally to the inside of the hands
- While rubbing it in, pay special attention to the areas between the fingers and to the nail beds



sensiva[®] protective emulsion

Product data

Ingredients:

Aqua, Paraffinum Liquidum, Cetearyl Ethylhexanoate, Glycerin, Simmondsia Chinensis (Jojoba) Seed Oil, Polyglyceryl-3 Methylglucose Distearate, Stearic Acid, Glyceryl Stearate, Isopropyl Myristate, Cera Alba, Allantoin, Sodium Polyacrylate, Xanthan Gum, Potassium Sorbate, Sodium Benzoate, Citric Acid

Chemical-physical data

Color	white
Density	approx. 0,98 g/cm ³ / 20 °C
Flash point	Not applicable
Form	emulsion
pH	approx. 5,0 / 20 °C
Viscosity, dynamic	approx. 1.000 mPa*s / 20 °C / Method : DIN 53019

Environmental information

schülke manufactures products economically and with advanced, safe and environmentally friendly production processes and in compliance with high quality standards.

Expert opinion and information

Please visit our website for an overview of all available literature/reports on the product: www.schuelke.com.

For individual questions:

Application Department

Phone: +49 40 52100-666

E-Mail: info@schuelke.com

Special advice

Store at room temperature in the original container. Keep out of direct sunlight

Information for order

Item	Delivery form	Item no.
sensiva protective emulsion 150 ml FL	30/Carton	on request
sensiva protective emulsion 150 ml FL	30/Carton	on request
sensiva protective emulsion 150 ml FL	30/Carton	on request
sensiva protective emulsion 500 ml FL	20/Carton	on request
sensiva protective emulsion 500 ml FL	20/Carton	on request
sensiva protective emulsion 500 ml FL	20/Carton	on request

These products are not available in every country. For more information please contact our local subsidiary or distributor.

Application aids

Application aids	Item no.
Dispenser KHK 500 (approx. 0.75-1.5ml per stroke)	669600
Product dispenser long arm 500 ml	669610
sm 2 500 (approx- 1.0-3.0ml per stroke)	668600
sm 2 Universal (approx. 1.0 - 3.0 ml per stroke)	668500

Related Products

- desmanol[®] pure
- sensiva[®] dry skin balm
- sensiva[®] protective cream
- sensiva[®] regeneration cream
- sensiva[®] wash lotion



Schülke & Mayr GmbH holds a Manufacturer's Authorisation according to sect 13 para 1 German Drug Law and Certificates of GMP Compliance for medicinal products.

schülke Headquarters
Schülke & Mayr GmbH
Robert-Koch-Str. 2
22851 Norderstedt, Germany
Phone +49 40 - 52100 - 0
Fax +49 40 - 52100 - 318
www.schuelke.com
info@schuelke.com